

## Appendix 3

1. Chris Glasson Plan, 15 November 2010
2. Cross section of completed road formation with mitigation 24 July 2010

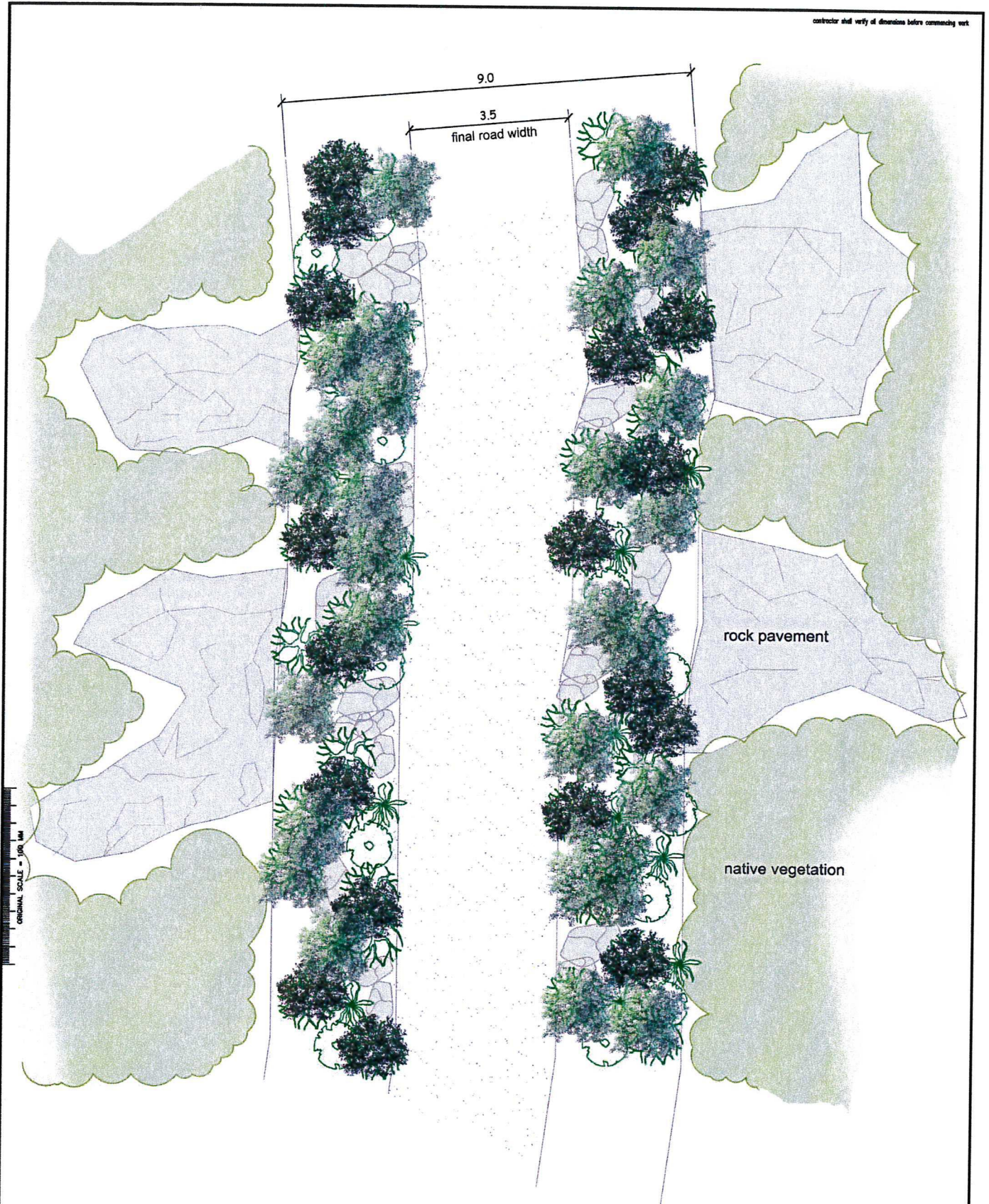



3. Plan view of completed road formation

CAD file: 19

CHRIS GLASSON  
Landscape Architects Ltd  
1922 Building 127 Aranga St  
Christchurch, New Zealand  
Phone: 375 0288  
Fax: 377 7639  
www.english.co.nz

Mt Cass Access Road Restoration

Batterslope Mitigation

design: CGL  
drawn: MDC  
checked: CD  
date: 12 Mar 10  
scale: E750A3

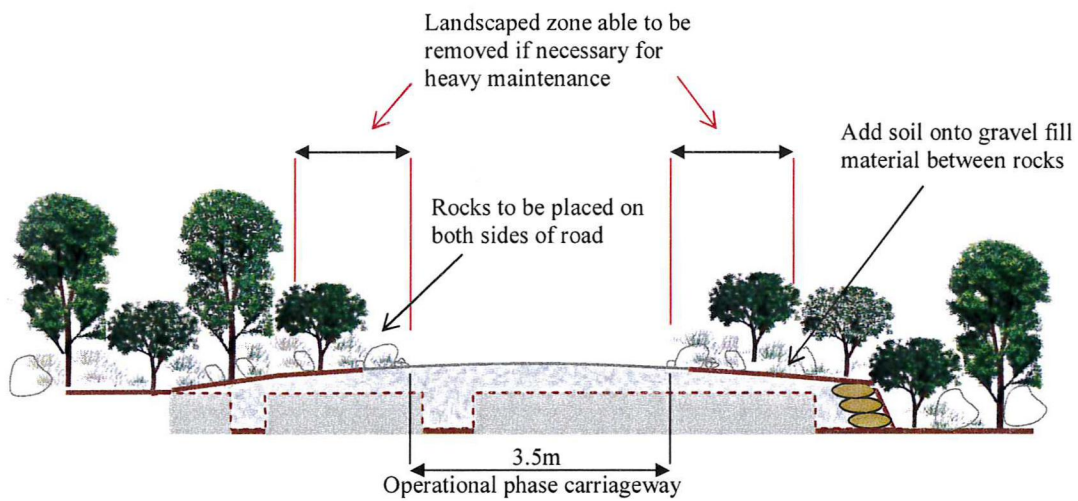
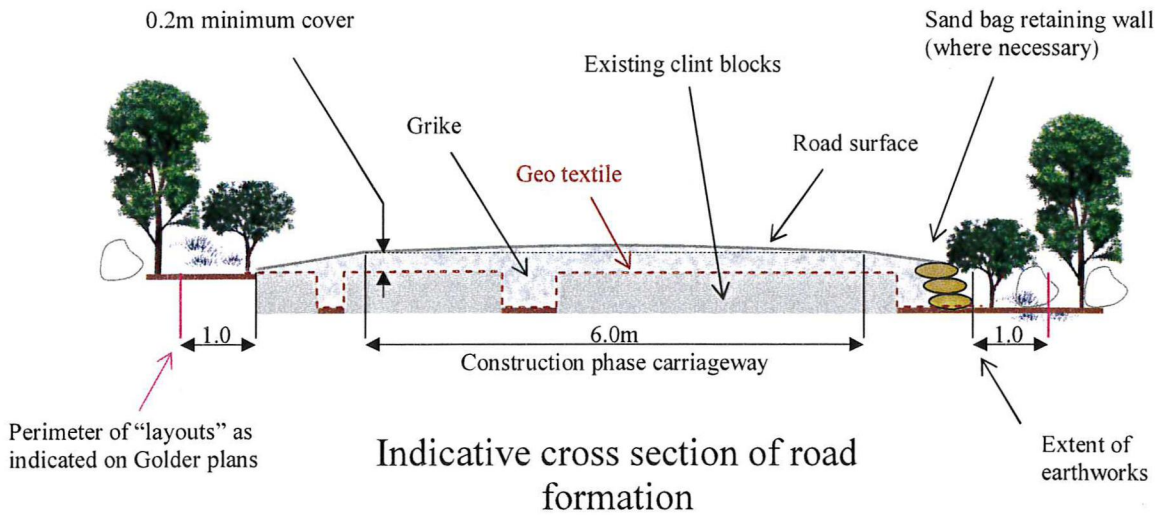

**Road crossing over limestone pavement between location 800 to 950**